

MD006006

Gearbox Specifications

Outer diameter	6mm	Bearing	Porous bearing	Rolling bearing
Material	Metal	Axial endplay	≤0.3mm	≤0.3mm
Direction of rotation	cw & ccw	Radial loading on output shaft	≤0.5N	≤5N
Gear backlash	≤3°	Operating temperature range	-20 ~ +85°C	

Gearbox Stages

	1	2	3	4
Reduction ratio	5 / 6	23 / 31 / 41	110 / 148 / 198 / 266	531 / 711 / 952 / 1275 / 1708
Max rated torque of gearbox (gf.cm)	330	330	330	600
Instant torque of gearbox (gf.cm)	800	800	800	1500
Gearbox efficiency (%)	87	74	63	56
Gearbox length L1 (mm)	9.7	12.1	14.5	16.9

Technical Drawing

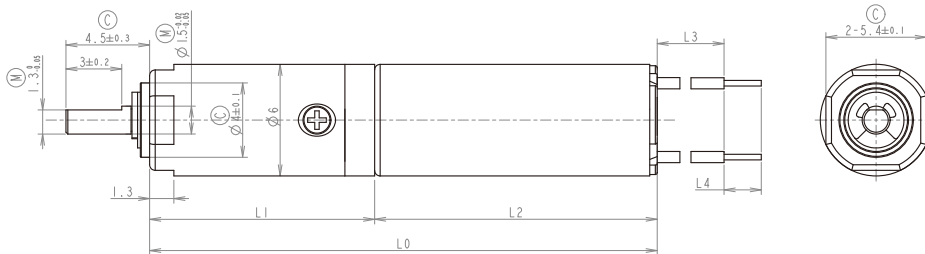

Motor Specifications

Motor type (optional)	Coreless motor, Stepper motor	Input speed	≤3000rpm
Voltage (optional)	3-12V	Current	100mA max

Model	Rated Speed	Max Speed	Max Rated Torque	Max Instant Torque	Reduction Ratio	Gearbox Length	Overall Length
	rpm	rpm	gf.cm	gf.cm		mm	mm
MD006006-5	1563	6250	330	800	4.8	9.7	23.7
MD006006-6	1166	4666	330	800	6.43		
MD006006-23	326	1302	330	800	23.04	12.1	26.1
MD006006-31	243	972	330	800	30.86		
MD006006-41	181	726	330	800	41.33		
MD006006-110	68	271	330	800	110.6	14.5	28.5
MD006006-148	51	203	330	800	148.1		
MD006006-198	38	151	330	800	198.4		
MD006006-266	28	113	330	800	265.7	16.9	30.9
MD006006-531	14	57	600	1500	530.8		
MD006006-711	11	42	600	1500	711.0		
MD006006-952	8	32	600	1500	952.2		
MD006006-1275	6	24	600	1500	1275.2		
MD006006-1708	4	18	600	1500	1707.9		

*Please contact us for customized products